



EXPANDABLE FRAMES

DESCRIPTION

➤ 3 Piece (Knock-down) frames for 1-3/4" (45) bevelled Hollow Metal or Wood Doors, designed for easy and rigid installation in completed walls. The frame is constructed to wrap the wall and then tightly "sandwich" the walls as the fasteners on the faces are secured to the wall. Fasteners not included, supplied by others.

MATERIAL:

➤ 16 ga. Galvannealed Steel - .40 oz per sq. . ft. (120 gm per sq.m.), passivated for easy paint application.

HINGE JAMB:

➤ Prepared for 1-1/2 pairs of 4-1/2" x 4 " (114 x 102) Templates Hinges – Regular Weight 0.134"(3.4) thickness with "dimples" that can be removed (grinding) for use with Heavy Weight Hinges 0.180" (4.57mm) thickness. Hinges not included.

➤ Countersunk screw holes are prepared, the length of the jamb, both faces, for fastening.

STRIKE JAMB:

➤ Prepared by ANSI-A 115.1 – 1-1/4" x 4-7/8" (32 x 124) Strike Assembly. Strike Plate not included.

➤ Prepared for 3 Rubber Silencers – Type 64. Not include from manufacturer, included from distributor.

➤ Countersunk screw holes are prepared, the length of the jamb, both faces, for fastening.

HEAD:

➤ Fire Rate Frame Headers must be properly reinforced for Surface Mounted Closers.

➤ Countersunk screw holes are prepared, the length of the jamb, both faces, for fastening.

ANCHORS

➤ Countersunk screw holes are prepared, the length/width of the jambs/head, both faces, for fastening.

FIRE LABELLING:

➤ Supplied with an Embossed 3/4 Hour to 1-1/2 Hour Fire Label for single and double frames.

MODEL	MINIMUM THROAT	MAXIMUM THROAT	SOFFIT
EF1	3-1/2" (89)	5-1/4" (133)	1-15/16" (49)
EF2	5-3/8" (137)	8-11/16" (221)	3-1/2" (90)
EF3	8-11/16" (221)	12" (305)	3-1/2" (90)

EXPANDABLE FRAMES

EXPANDABLE FRAMES

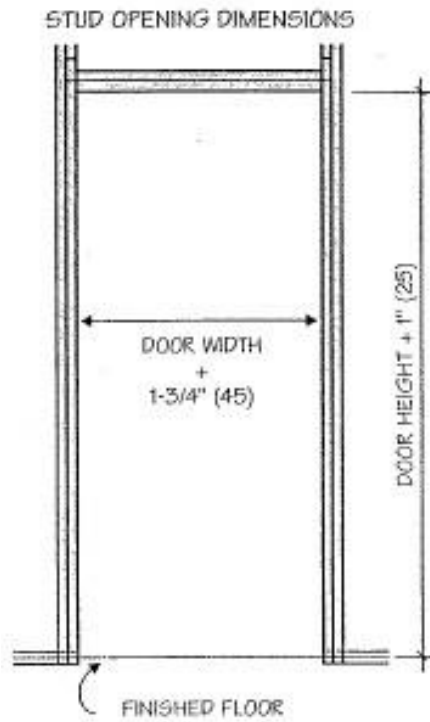

INSTALLATION OPTIONS

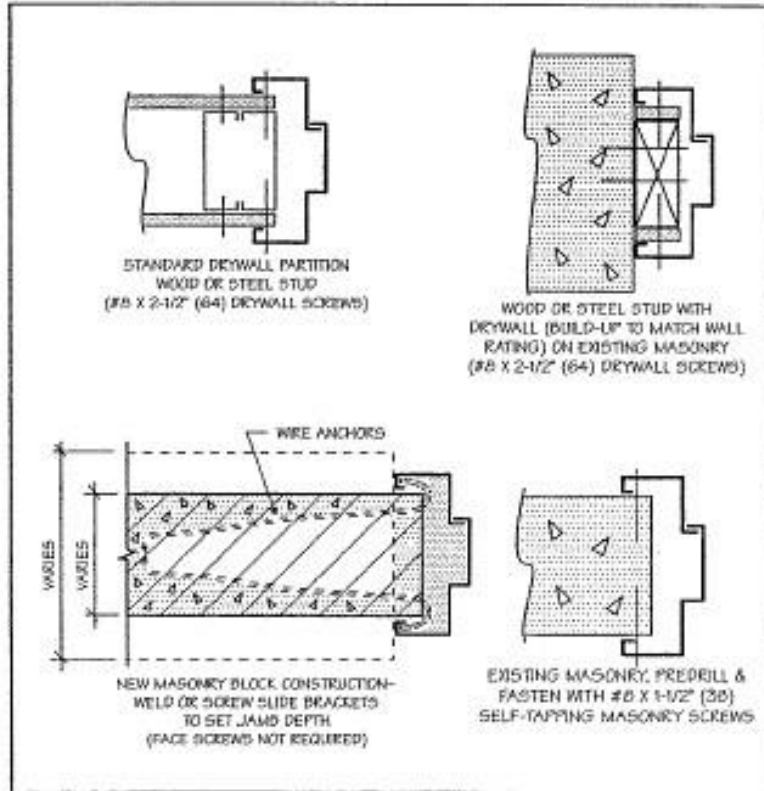

STANDARD INSTALLATION DETAILS

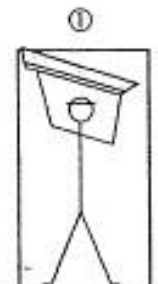

1 Install header.

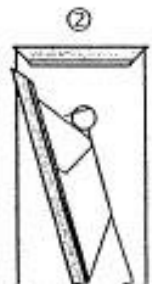

2 Install hinge jamb. Ensure tabs on jamb are located through slots in header.

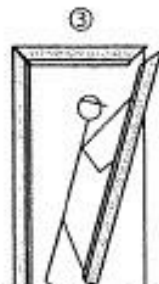

3 Install strike jamb in same manner as hinge jamb.

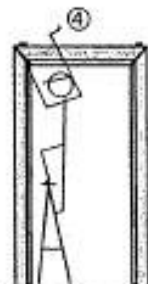

4 Pull down header and secure by bending top jamb tabs (4) towards wall.

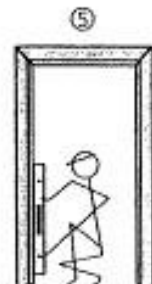

5 Plumb both jambs, ensuring frame is centred in opening.

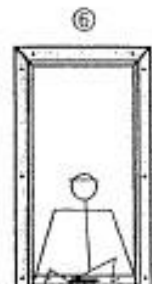

6 Check frame is plumb, square & true; secure to wall with screws through face both sides.